

# Instructions for installing a latch assembly for cupboards and drawers



## Precautions

- Must be assembled by an adult
- During assembly, keep the parts out of children's reach

## Materials required

- Lead pencil
- Star head screwdriver

## Installation

- Remove the film from one side of the double adhesive tape included and fix it on each side of the piece of furniture where it will be installed.
- Place the hook 2.5 cm (1") from the inner edge of the cupboard (Figure A) and mark the position with a lead pencil. Remove the film from the adhesive tape and fix the hook on the mark. Screw the hook in place using the screws included.
- Place the latch so that it catches onto the hook when the door is opened approximately 4 cm (1 1/2") (Figure B). Mark the position of the latch using a lead pencil. Remove the film covering the adhesive tape and fix the latch on the mark. Check the alignment of the latch and hook before screwing the latch. Screw the latch in place using the screws included.

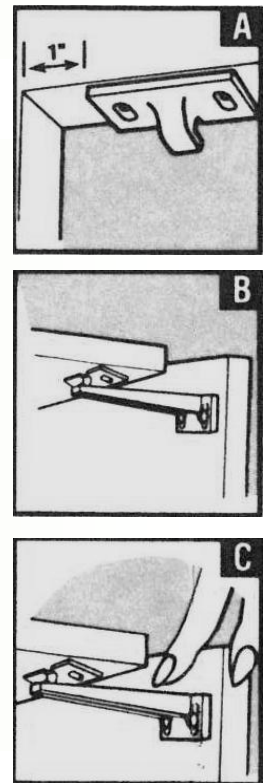

## Instructions for use

- When the drawer or door is opened approximately 4 cm (1 1/2"), the latch will catch on the hook. To open the door or drawer completely, push the latch down with your finger (Figure C).

## Attention

- This product has a dissuasive effect only. It cannot replace adult supervision. Stop using it when the child is big enough to remove it. Toxic and dangerous products, as well as sharp objects must be stored in places that are out of a child's reach.

# Warning for smoke detectors

- It is now recommended to install the detector and its battery in the hall (not in the kitchen, it can set off a false alarm)
- Press the test button to make sure the detector functions
- Depending on the model provided in the kit, in the event the alarm is caused by cooking, steam, etc., press on the detector's alarm stop button (Hush)
- **NEVER remove the battery** when there is a false alarm
- If you already have one detector, place the 2<sup>nd</sup> farther away in the house (see instructions): two detectors are better than one



## Home injury prevention kit